

接线图
Wiring Diagram

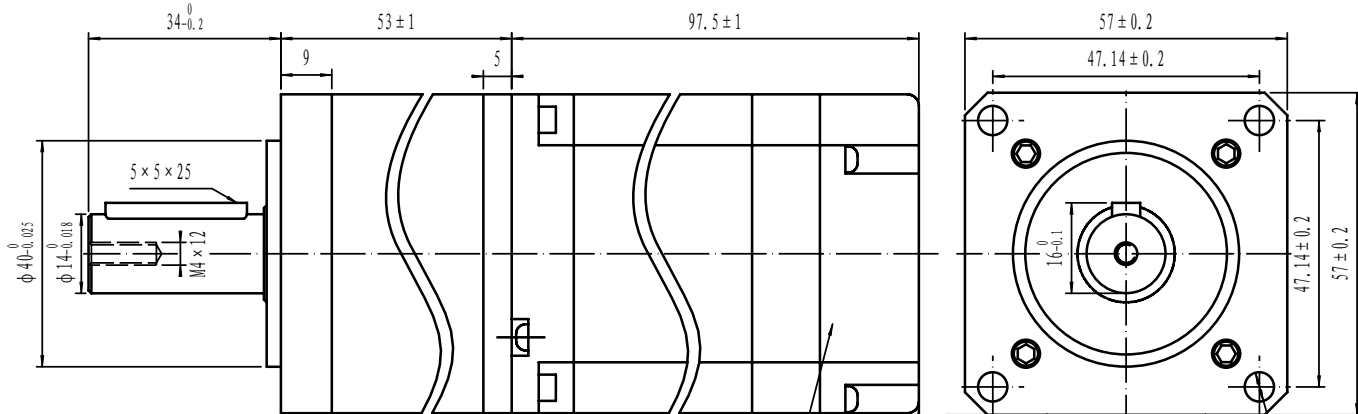

规格 SPECIFICATIONS

1	相数 Number of Phase	3
2	步距角 Step Angle	1.2° ± 5%
3	保持力矩 Holding Torque	15 Kg. cm
4	电压 Voltage	3.5 VDC
5	电流 Current	5.8 A
6	相电阻 Phase Resistance (20°C)	0.6 ± 10% Ω
7	相电感 Phase Inductance (1KHz)	2.3 ± 20% mH
8	转子惯量 Rotor Inertia	g. cm ²
9	绝缘电阻 Insulation Resistance	100MΩ 500VDC
10	绝缘等级 Insulation Class	B (130°C)
11	环境温度 Ambient Temperature	-20°C to 50°C
12	环境湿度 Ambient Humidity	15% to 95%
13	电机重量 Motor Weight	kg
14	速比 Reduction Ratio	5: 1

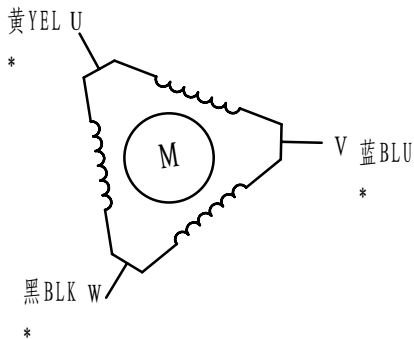
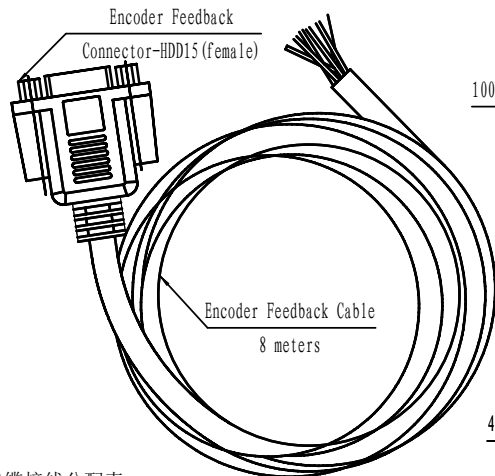

编码器线缆接线分配表:

颜色	代号	I/O	描述
红	VCC	I	+5V 直流电源输入, 最大电流小于100mA
白	EGND	GND	信号、电源接地
蓝	EA-	0	编码器通道A-输出
黑	EA+	0	编码器通道A+输出
绿	EB-	0	编码器通道B-输出
黄	EB+	0	编码器通道B+输出

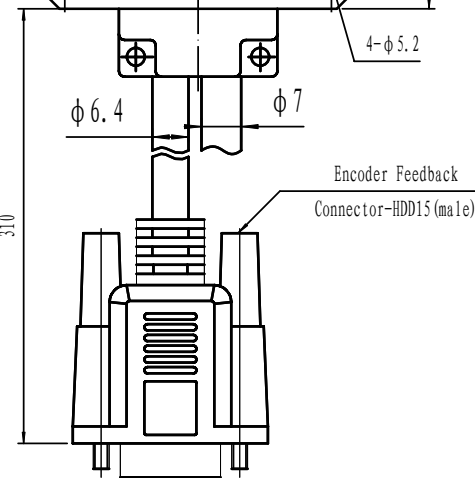
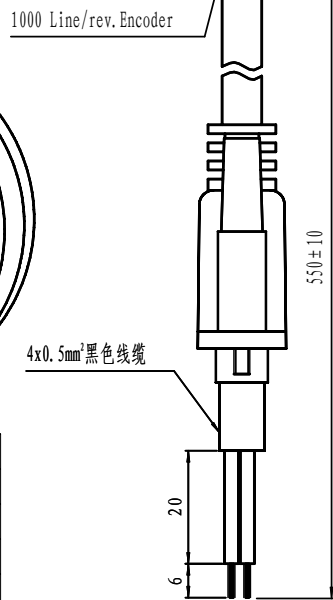

EncoderFeedBack Cable wires Assignment

Color	Name	I/O	Description
Red	VCC	I	+5V@100 mA max
White	EGND	GND	Signal ground and power ground
Blue	EA-	0	Encoder channel A- output
Black	EA+	0	Encoder channel A+ output
Green	EB-	0	Encoder channel B- output
Yellow	EB+	0	Encoder channel B+ output

The max allowable troque(box) is 65 Kg. cm

参数同 57BHP80-58A-30Mp

Unit:mm
第一角画法
First angle method
未注线性与角度尺寸公差
Tolerances for linear and angular dimensions without individual tolerance indications
GB/T 1804-m eqv ISO 2768-1:m
未注形状与位置尺寸公差
Geometrical tolerances for features without individual tolerance indications
GB/T 1184-k eqv ISO 2768-2:k

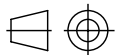

设计 DESIGN	XH	20151204
校核 CHECK		
工艺 TECHNOLOGY		
标准化 STANDARD		
批准 APPROVE		
NAMES	SINGATURE	DATE

CW-motor



常州创伟电机电器有限公司

Changzhou Chuangwei Motor & Electric Apparatus Co.,Ltd

TYPE: HYBRID STEPPING MOTOR SCALE: 1.4 ReW1.0 SHEET 1 OF 1

Model: 57BHP80-580A-08Mp (PL5K)

V1.0	HTPS1511252	20151204
REV.	版本记录 REVISION RECORD	DATE